

### Performance & Use

- Fast WiFi speeds 150/433Mbps–AC600 WiFi
- Works with 802.11 a/b/g/n and ac WiFi routers
- Stream HD videos simultaneously

### The NETGEAR Difference - A6100

- Convenient mini-design
- Push 'N' Connect–Push button security



### Overview

The NETGEAR AC600 WiFi Dual Band Adapter wirelessly connects your notebook or desktop computer to an 11ac network for applications such as lag-free, HD streams throughout your home, online gaming and a secure and

reliable connection to the Internet. It is compatible with AC WiFi devices and backward compatible with 802.11 a/b/g/n devices. The AC600 WiFi Adapter delivers speeds up to 150/433Mbps<sup>†</sup> and dual band WiFi technology reduces

interference for better connections to more WiFi devices. With the NETGEAR Push 'N' Connect feature, enjoy a secured wireless Internet connection, at the push of a button. Works with any WiFi router.

### Push 'N' Connect (WPS)

A secured connection at the push of a button<sup>1</sup>

#### STEP 1

Plug in to computer and push the button on the adapter

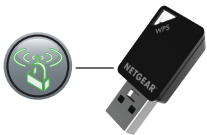

#### STEP 2

Push the Push 'N' Connect button on the router

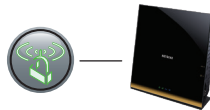

#### STEP 3

Secure wireless connection



<sup>1</sup> Works with devices supporting Wi-Fi Protected Setup® (WPS).

**Speed**

Extreme download speeds of up to 150/433Mbps†. 11ac WiFi with dual band technology provides whole home coverage and everything you need for a fast connected home.



**FAST WIFI SPEEDS**—150/433Mbps† speeds

**WiFi Range**

The AC600 WiFi Adapter boosts WiFi connectivity throughout your small or medium-sized home for all your Internet-enabled devices.



**EXTENDED RANGE**—Wireless coverage throughout your small or medium-sized home

**Reliable Connections**

Stay connected—with your devices, your media, and your friends. Dual band WiFi provides two separate WiFi networks—2.4GHz for legacy devices and 5GHz which is less interference-prone for media streaming.



**DUAL BAND**—Reduces interference for better connections to more WiFi devices

**Ease Of Use**

Use Push 'N' Connect to add devices to your home network with a push of a button.



**COMPATIBLE**—Works with 802.11 a/b/g/n and ac WiFi routers



**PUSH 'N' CONNECT**—Easy push button WiFi connections (WPS)

**Applications**

With the AC600 WiFi Adapter, connect a laptop computer to an 11AC home network for applications such as lag-free HD streaming, online gaming, reliable connection to the Internet, and a secure wireless connection.

**Ideal uses**

Emailing, chatting, surfing, music and video streaming



Optimized for smooth HD streaming & online gaming



Enjoy high-quality HD streaming

**Package Contents**

---

- Wireless AC600 Adapter (A6100)
- Quick install guide

**Physical Specifications**

---

- Dimensions: 36.1 x 18.4 x 8.1 mm (1.42 x .724 x .318 in)
- Weight: 8 g (0.28 oz)

**Warranty**

---

- [www.netgear.com/warranty](http://www.netgear.com/warranty)

**Standards**

---

- IEEE<sup>®</sup> 802.11 b/g/n 2.4GHz
- IEEE 802.11 a/n/ac 5GHz

**System Requirements**

---

- Intel<sup>®</sup> Pentium<sup>®</sup> class PC
- Available USB 1.1 or USB 2.0 slot
- Microsoft<sup>®</sup> Windows<sup>®</sup> 7, 8, 8.1, 10, XP, 11: (32/64-bit)

Supports  
Windows 11

Comes with a limited warranty that is valid only if purchased from a NETGEAR authorized reseller.

\*90-day complimentary technical support following purchase from authorized reseller.

†Maximum wireless signal rate derived from IEEE 802.11 specifications. Actual data throughput and wireless coverage will vary and may be lowered by network and environmental conditions, including network traffic and building construction. NETGEAR makes no warranties about compatibility with future standards.

‡Works with devices supporting Wi-Fi Protected Setup<sup>®</sup> (WPS).

Country settings must be set to location where used. For indoor use only in EU and EFTA countries.

NETGEAR, and the NETGEAR Logo are trademarks of NETGEAR, Inc. Any other trademarks mentioned herein are for reference purposes only.  
© 2022 NETGEAR, Inc. All rights reserved.